

PS-H-M12N23 Instructions for Proximity sensor (V2.2)

- The device to overcome the photoelectric and traditional flat-layer switch inherent vulnerability of the shortcomings, high reliability and precision and fast response capability, low price Very high price.

Note: Sensor output type is distinguished by cap color:Co-positive type is Blue ;Co-negative type is Black.

§ Please pay attention to the output type and output status when ordering, and refer to the system wiring principle and wiring diagram in the manual when installing and debugging, otherwise, the company will not take any responsibility for the damage or failure to use the product.

● Main characters:

1. The output signal is the square wave pulse signal, and the response speed is fast and reliable.
2. Ultra-low consumption current: 16mA, long service life.
3. The circuit has the protection function of power reverse protection, short circuit protection and preventing misoperation.
4. The circuit has anti-plus or minus 6KV static electricity, plus or minus 4.5Kv group pulse and surge protection function.
5. Electrical performance meets the requirements of "international electrotechnical commission (IEC)";
6. High reliability, small volume and convenient installation and debugging.Simple structure and low price.

● Technical Specification:

1	Application Range:	Applicable to all need to proximity sensor elevator
2	Power supply:	DC 24V($\pm 10\%$), Machine operating current $\leq 50\text{mA}$
3	Current consumption	16mA
4	Install Position:	M12*102
5	Installation:	Non-flush installation
6	Output form:	Co-positive type
		Co-negative type
7	Working temperature:	-25~55℃
8	Working environment humidity:	35%~85%RH
9	Protection class:	IP53
10	Withstand voltage:	AC1000V , 50Hz, one minute
11	Insulation resistance:	DC500V, $\geq 20\text{M}\Omega$,

● System wiring principle:

No.	Cable color	Wiring instructions
1	棕色 (Brown)	+DC24V
2	蓝色 (Blue)	Com
3	黑色 (Black)	Signal output

● **Product wiring diagram**

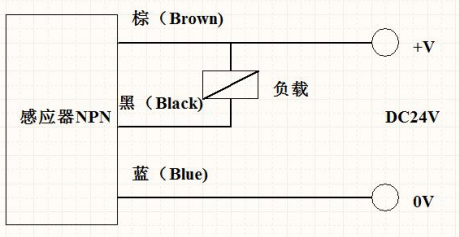
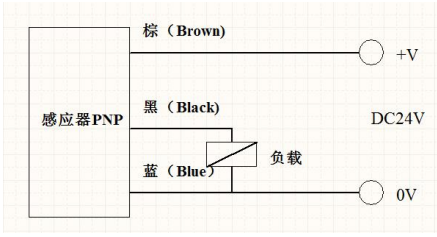
Output type	Proximity switch wiring diagram		
Co-positive type		Co-negative type	

● **Product size:**

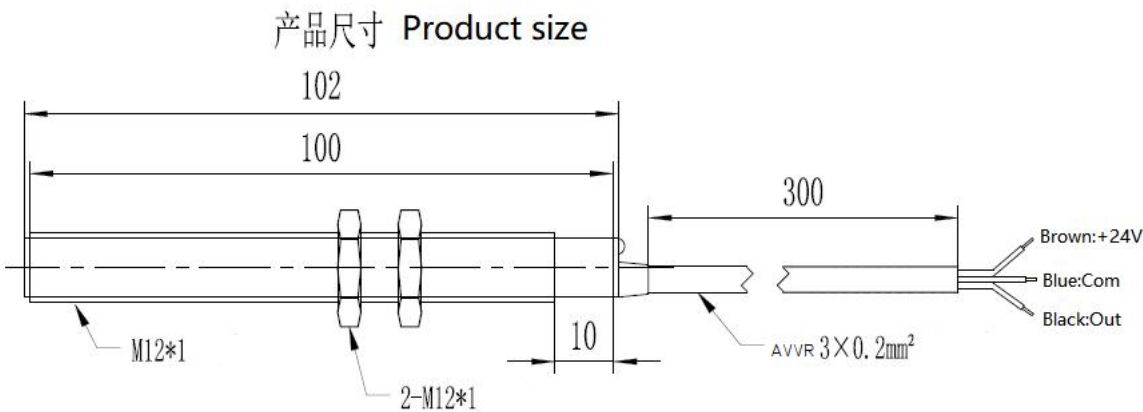

● **Other:**

attachment: User Guide

1 piece M12

2 sets

● **support:**

If an exception occurs during debugging or use, Please contact with me.

support: 18092639752 or 18092639750